

# RCD Switched Sockets - 30mA Passive

# -PowerBreaker-

- + Mechanically latched (does not need resetting after a power loss)
- + Red & Green dual flag system to show power on/off
- + High intensity LED power on indicator
- + Cuts the power for added protection against electrocution
- + Twin earth terminals on Twin sockets
- + White sockets fit standard 35mm back box

**Type A RCD**  
**BS 7288-2016+A1:2022**

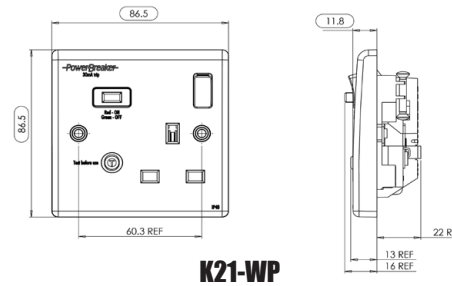

**K21-WP**

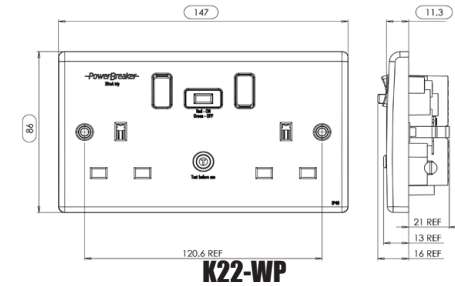

**K22-WP**

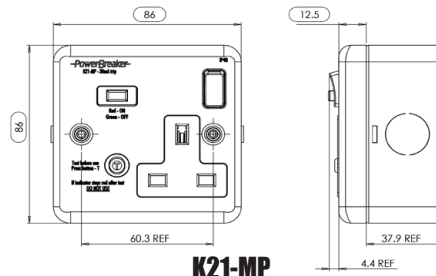

**K21-MP**

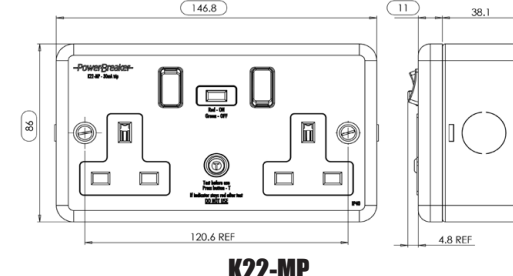

**K22-MP**

	<b>K21-WP</b>	<b>K22-WP</b>	<b>K21-MP</b>	<b>K22-MP</b>
<b>Product Finish</b>	White	White	Metalclad	Metalclad
<b>Barcode</b>	5012739646843	5012739646850	5012739646867	5012739646966
<b>Product Weight</b>	152.5g	236.5g	358g	529g
<b>Product Dimensions</b>	86.5 x 86.5 x 12mm	147.5 x 86.5 x 12mm	86 x 86 x 49mm	147.5 x 86.5 x 49mm
<b>Voltage</b>	230V AC ~ 50Hz			
<b>Max Operating Current</b>	13A (13A Inductive)			
<b>IP Rating</b>	IP40			
<b>Rated Trip Current</b>	30mA			
<b>Typical Trip Speed</b>	Less than 20ms (typical)			
<b>RCD Contact Break</b>	Double Pole			
<b>Rated Short Circuit Breaking &amp; Making Capacity</b>	250A			
<b>Rated Conditional Short-Circuit Current</b>	1500A Power Factor Range .93 to .98			
<b>Latching</b>	Mechanical - No need to reset after Power Loss (Passive)			
<b>Responsive To</b>	Pulsating DC earth faults			
<b>Terminal Capacities</b>	Upto 3 x 1.5mm <sup>2</sup> / 3 x 2.5mm <sup>2</sup>			
<b>Main Housing Material</b>	Urea		Steel & Polycarbonate	
<b>Guarantee</b>	3 Years			
<b>Conforms To</b>	BS 7288-2016+A1:2022, BS1363-2:2016+A1:2018			

TECHNICAL DATA SHEET

**GREEN BROOK**

Tel: 01279 772 772  
Email: sales@greenbrook.co.uk  
www.greenbrook.co.uk



# RCD Unswitched Sockets - 30mA Passive

-PowerBreaker-

- + Mechanically latched (does not need resetting after a power loss)
- + Red & Green dual flag system to show power on/off
- + High intensity LED power on indicator
- + Cuts the power for added protection against electrocution
- + Twin earth terminals
- + H22-WP fit standard 35mm back box

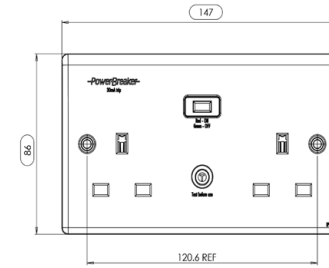

H22-WP

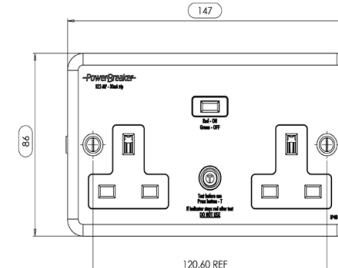
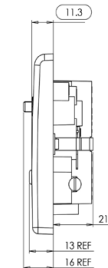

H22-MP

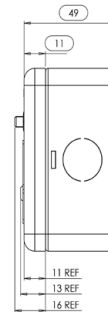

**Type A RCD**  
**BS 7288-2016+A1:2022**



	H22-WP	H22-MP
Product Finish	White	Metalclad
Barcode	5012739646805	5012739646812
Product Weight	238g	514g
Product Dimensions	147.5 x 86.5 x 12mm	147.5 x 86.5 x 49mm
Voltage	230V AC ~ 50Hz	
Max Operating Current	13A (13A Inductive)	
IP Rating	IP40	
Rated Trip Current	30mA	
Typical Trip Speed	Less than 20mS (typical)	
RCD Contact Break	Double Pole	
Rated Short Circuit Breaking & Making Capacity	250A	
Rated Conditional Short-Circuit Current	1500A Power Factor Range .93 to .98	
Latching	Mechanical - No need to reset after Power Loss (Passive)	
Responsive To	Pulsating DC earth faults	
Main Housing Material	Urea	Steel & Polycarbonate
Guarantee	3 Years	
Conforms To	BS 7288-2016+A1:2022, BS1363-2:2016+A1:2018	

**GREEN BROOK ELECTRICAL**

Tel: 01279 772 772

Fax: 01279 422 007

Email: sales@greenbrook.co.uk

www.greenbrook.co.uk

