

Cable Ties - Stainless Steel

NORSLO

- + Self locking head design - 'roller ball locking' & locks into place at any length along the body
- + Provides a strong, durable method of cable bundling
- + Can be used indoor, outdoor and underground (including direct burial)
- + Stainless Steel bases compliment S/S cable ties (see overleaf)
- + Stainless Steel grade AISI.304

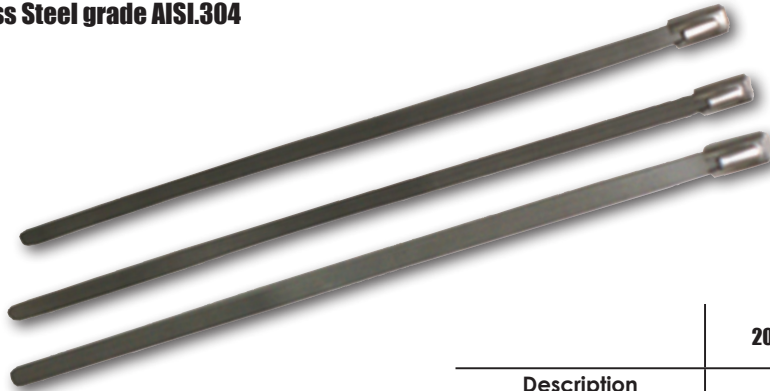

| | 200/46SS | 300/46SS | 360/46SS |
|----------------------------------|--------------------------------|---------------|---------------|
| Description | Stainless Steel Cable Ties | | |
| Barcode | 5012739612602 | 5012739613944 | 5012739614316 |
| Pack Qty | 100 | | |
| Dimensions (mm) | L200 x 4.6mm | L300 x 4.6mm | L360 x 4.6mm |
| Working Temperature | -80°C - +538°C | | |
| Minimum Installation Temp | -60°C | | |
| Material | Stainless Steel grade AISI.304 | | |
| Weight (g) | 2g | 3.4g | 3.8g |
| Tested To | UL62275 | | |
| Conforms To | BS EN IEC 62275:2019 | | |

Cable Ties Bases - Stainless Steel

NORSLO

- + Stainless Steel bases, designed to compliment S/S cable ties
- + Can be used with cable ties upto 10mm wide
- + Stainless Steel grade AISI.304

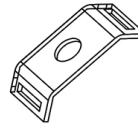
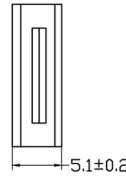
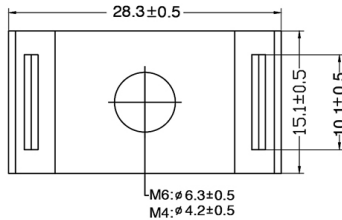

| | SSBM4 | SSBM6 |
|----------------------------|--------------------------------|---------------------------|
| Description | Stainless Steel Bases | |
| Barcode | 5012739648380 | 5012739648397 |
| Pack Qty | 100 | |
| Dimensions (mm) | L28.3 x W15.1 X H5.1mm | L28.3 x W15.1 X H5.1mm |
| Fixing Hole Size | 4.2mm (M4) | 6.3mm (M6) |
| Max Tie Width | 10 | |
| Material Thickness | 1mm | |
| Working Temperature | -80°C - +538°C | |
| Material | Stainless Steel grade AISI.304 | |
| Weight (g) | 3g | |